

## A141E Constant Volume Extract Grille with Timed Boost specification document

The A141E constant volume extract grille with timed boost is designed for 'wet rooms', allowing a low level of continuous ventilation ( $25\text{m}^3/\text{hr}$ ), with an added boost facility to increase ventilation to  $90\text{m}^3/\text{hr}$ , when required, for a timed period of 30 minutes.



### Operation

The A141E extract grille incorporates a specially designed flexible rudder which allows the extract to self regulate and ensure that ventilation does not increase above the desired level. In addition, the extract is electrically connected to a remote boost switch, which allows occupants to boost ventilation for a period of 30 minutes.



The extract forms part of a whole house mechanical ventilation solution, and are located in 'wet rooms' such as kitchens, utility rooms, bathrooms, en-suites and WC's.

Extracts are ducted to a centrally located, continuously running extract fan which drives the ventilation system.

The A141E is particularly suited as part of a whole house ventilation solution whereby a constant level of ventilation is wanted for the majority of the time, whilst still offering occupants the option to boost ventilation.

The timed facility ensures that ventilation does not remain at the high rate when it is not wanted, but instead returns to the desired constant level after 30 minutes.

### Features

#### Energy Efficiency

The timed element ensures that ventilation does not remain at a high rate for unwanted prolonged periods.

#### Occupant Comfort

Ensures that the room in which it is situated is not over ventilated for long periods of time by returning to constant level after 30 minutes.

#### Occupant Control

The extract allows occupants an element of control to increase ventilation as and when required.

#### Visually Unobtrusive

The attractive design ensures that the extract is aesthetically pleasing to the occupant.

#### Flexibility

The A141E Extract Grille can be either wall or ceiling mounted.

Example of boost function

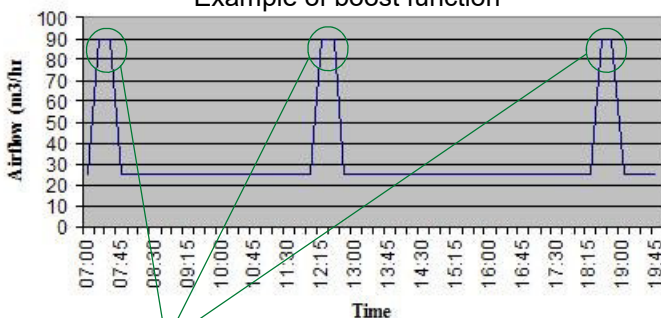

Boost switch pressed here and increases ventilation to the high rate of  $90\text{m}^3/\text{hr}$  for a period of 30 minutes.

When the boost switch is not pressed the ventilation rate remains at a constant rate of  $25\text{m}^3/\text{hr}$ .



The diagram on the left illustrates how the timed boost function allows the occupant to increase ventilation rate as and when required for a period of 30 minutes.

## A141E Constant Volume Extract Grille with Timed Boost specification document

<b>Airflow @ 80Pa</b>	Constant:	25m <sup>3</sup> /hr (7l/s)
	Boost:	90m <sup>3</sup> /hr (25l/s)
<b>Opening Area:</b>	Constant:	280mm <sup>2</sup>
	Boost:	1010mm <sup>2</sup>
<b>Control Method:</b>	Self Regulating + A132 Boost Switch <i>(sold separately)</i>	

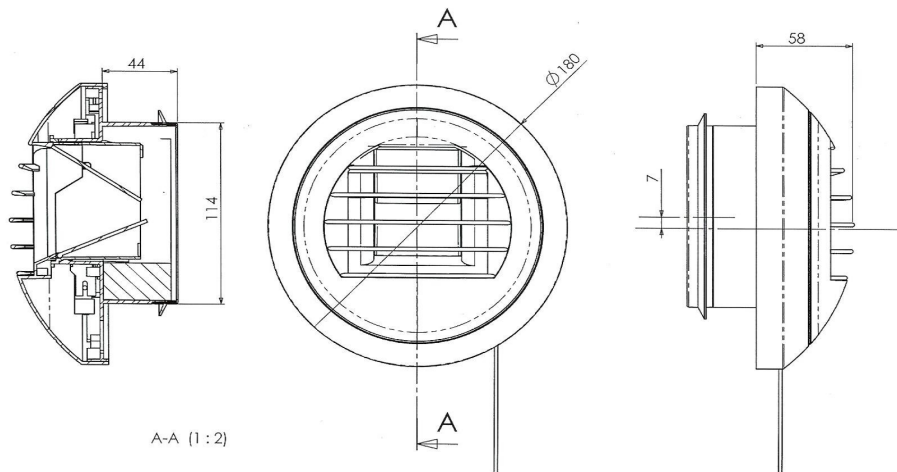

A-A (1 : 2)

Dimensions	
External Diameter:	180mm
Thickness:	58mm
Spigot Diameter:	125mm

### WIRING

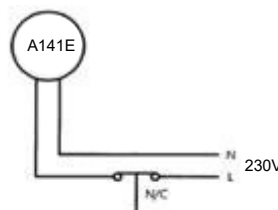

A132 Timed Boost Switch (Spring Return)



A132 boost switch

Extract Grille	Standard Operation Range	Additional Boost	Use with Boost Switch	Power Supply	
				Mains	Battery
A141E	Constant volume 25m <sup>3</sup> /hr (7l/s)	30 min timed boost @ 90m <sup>3</sup> /hr (25l/s)	A132	230v	None